

# Touring Tuscany · 1/4" scale Shop Front Vignette

By Cat Wingler, Southport, North Carolina • 2014 Small Scale Regional Housparty

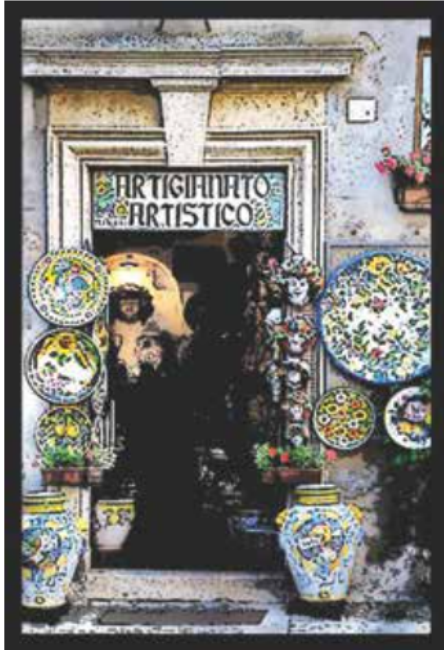

We spent a day in Viareggio, the town that was the birthplace of Carnevale. It was Amazing, I loved the mask shops and the costume shops, and all of the other shops and ....., Drat, (OK, I didn't really say drat but you get the idea,) Drat, I ran out of money way early so I went back to the room and started working on the little shop front in 1/4" scale. I got the patterns made and the pieces cut and glued together. I think it's an easy project, you can use up some of the scraps of wood and mat board and it turned out so cute!

Here's the pattern and instructions for the basic structure. I'm going with them to dinner now (well, somebody has to watch'em) so I'll send the instructions for painting and framing next time.

Hugs,  
Cat



Framed and matted Vignette.

## Supplies and Tools

Note: these are mostly small pieces so rummage thru the scrap pile before you buy stuff.

- 1 piece of plain white mat board 2" x 3"
- 1 piece 1/16" x 1/16" at least 10" long
- 1 piece 1/8" x 1/32", 4" long
- 1 piece 1/16" x 1/4" at least 3" long
- 1 piece 1/8" x 3/8" at least 2" long
- 1 piece 1/4" x 1/4" at least 1" long

- X-acto Knife and new blades
- Cork backed ruler
- Pencil
- Cutting mat
- Emory Board

Refer to the Layout if necessary

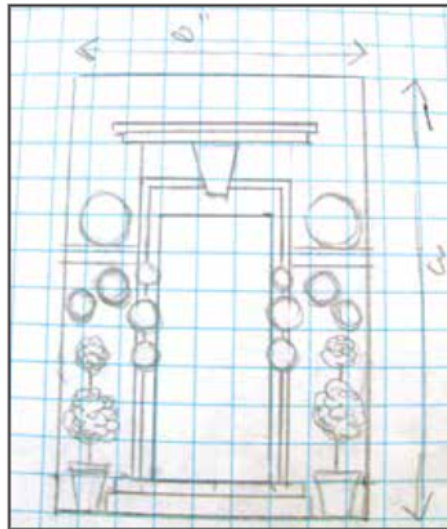

## Getting Started

- Cut out the Pattern out of mat board
- Mark bottom edge 3/16"
- Mark 1/8" over top of door opening
- Mark 1/8" on each side of door opening.



## Frame the Door

- Cut 2 pieces 1/16" x 1/16" to 2-1/8"
- Glue one on each side of the door on the inside of the lines. Remember to keep them above the bottom marks.
- Mark and cut a piece to go at the top between the side pieces.



## The Architectural Trims

- Cut 1 piece of 1/16" x 1/16" to 1-1/2"
- Cut 1 piece of 1/8" x 1/32" to 1-7/16"
- Center the short piece flush to the back edge of the long piece and glue them together.
- Glue them to the mat board centered 1/4" above the door trim.

— Continued on next page

# 1/4" scale Shop Front Vignette

— Continued



## Cut the Porch parts

- Cut 1 piece of 1/16" by 1/8" to 1" long
- Cut 1 piece of 1/8" x 1/4" to 1-1/8" long
- Cut 2 pieces of 1/16" x 1/8" to fit inside the door.
- Cut 2 pieces 1/8" at least 1" long.

## Make the porch

- Center and glue the 1" piece of 1/16" x 1/4" to the 1-1/8" piece of 1/8 x 3/8"
- Keep the back edges flush.
- Glue the steps to the front of the shop.



## Make the Back Braces

- Cut a piece of 1/16" x 1/4" to fit inside the door opening.
- Glue the 1/16" piece inside the door.
- Glue one of the 1/8" x 1/4" pieces to the back side under it.
- Glue one piece 1/4" x 1/4" to the top edge.

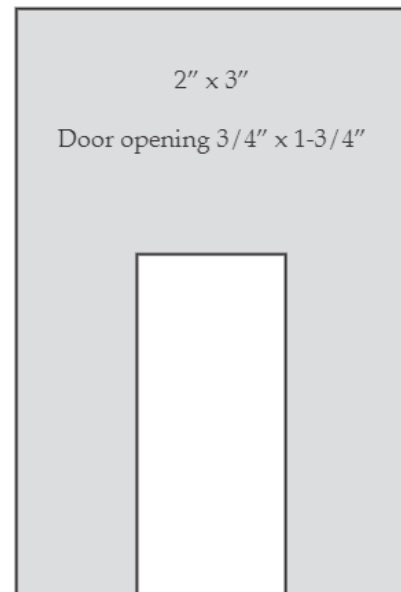

## Make the side trims

- Mark 1-7/16" from the bottom edge on both sides.
- Cut 2 pieces 1/16" x 1/16" to 1/2"
- Cut 2 pieces 1/8" x 1/32" to 1/2"
- Glue the 1/16" x 1/16" on the under side of the line.
- Glue the 1/8" x 1/32" on the top of the side pieces.
- Use an Emory board to make sure the outside edges are flush.

## ON LINE HOUSEPARTY

### Our Miniature World



April 22 - 27, 2014

- Centerpieces • Souvenirs •
- Tote Bag Favors •
- Swaps • Door Prizes •
- Houseparty Helpers •
- Roundtables • Theme Luncheon •
- Gala • Workshop • Auction •
- Souvenir Book •
- Houseparty Pin •
- Home Improvement Seminars •

More information on page 8



## International Guild of Miniature Artisans

IGMA was founded to promote fine miniatures as an art form; to increase awareness and appreciation of high-quality workmanship through public education; to recognize and honor qualified artisans and encourage work of highest quality; to encourage the development of new artisans; and to coordinate and serve the interests and needs of the artisan and non-artisan.

## Guild Study Program



Williamsburg, Virginia  
January 17-20, 2014

For more details visit: [www.igma.org](http://www.igma.org)